



PALM HILLS
DEVELOPMENTS

**BUILDING
ON**

ZAMALEK:

1, El Kamel Mohamed St.
Tel: 202 27375530 - 31 - 32 - 33

6TH OF OCTOBER:

Palm Hills October (Palm Club)
Tel: 202 3886 0103-04
Ext.: 8812

HELIOPOLIS:

22, Nehro St.
Tel: 202 24546367 - 68

MAADI:

Villa 81, Road 250
Tel: 202 23785194 - 23596580

DUBAI:

Almanara Tower
Office # 1911, Business Bay
Dubai, UAE
Tel: +971555944601

ALEXANDRIA:

19, Kafr Abdo St.
Tel: 203 5414041 - 42



palmhillsdevelopments.com



PALM HILLS
OCTOBER

Golf Extension
Type M



About the Project

- Built on 310 feddan.
- Located at 6th October City.
- Master planning, design and landscaping by Shehab Mazhar Architects.
- Palm Club.
- Beside the Golf Course.
- E-Compound.
- 24 hour security.
- Property Management.

Average Land Area	600.00 m²
Total Built up Area (Covered)	386.55 m²

Ground Floor Area	175.30 m²
Vestibule	2.00m x 5.60m
Reception & Dining	4.00m x 7.00m - 5.30m x 4.75m
Kitchen	3.80m x 3.55m
Toilet	2.50m x 1.20m
Guest Bedroom - Ensuite Bathroom	4.00m x 3.85m - 1.25m x 2.60m
Nanny's Room - Bathroom	3.80m x 2.00m - 1.40m x 1.90m
Driver's Room - Bathroom	2.30m x 2.00m - 1.40m x 1.90m

First Floor Area	167.65 m²
Master Bedroom - Ensuite Bathroom - Dressing	4.10m x 4.00m - 2.90m x 1.60m - 2.90m x 1.60m
Bedroom 1 - Bathroom 1	3.75m x 3.85m - 3.25m x 1.30m
Bedroom 2 - Terrace 2 - Bathroom 2	3.80m x 4.00m - 3.95m x 1.60m - 2.35m x 2.35m
Family Living - Terrace 1	4.45m x 4.75m - 4.90m x 2.75m

Penthouse Area	43.60 m²
Family Living	4.10m x 3.30m
Bathroom	2.20m x 1.45m
Roof Terrace	102.85m ²



Ground Floor



First Floor

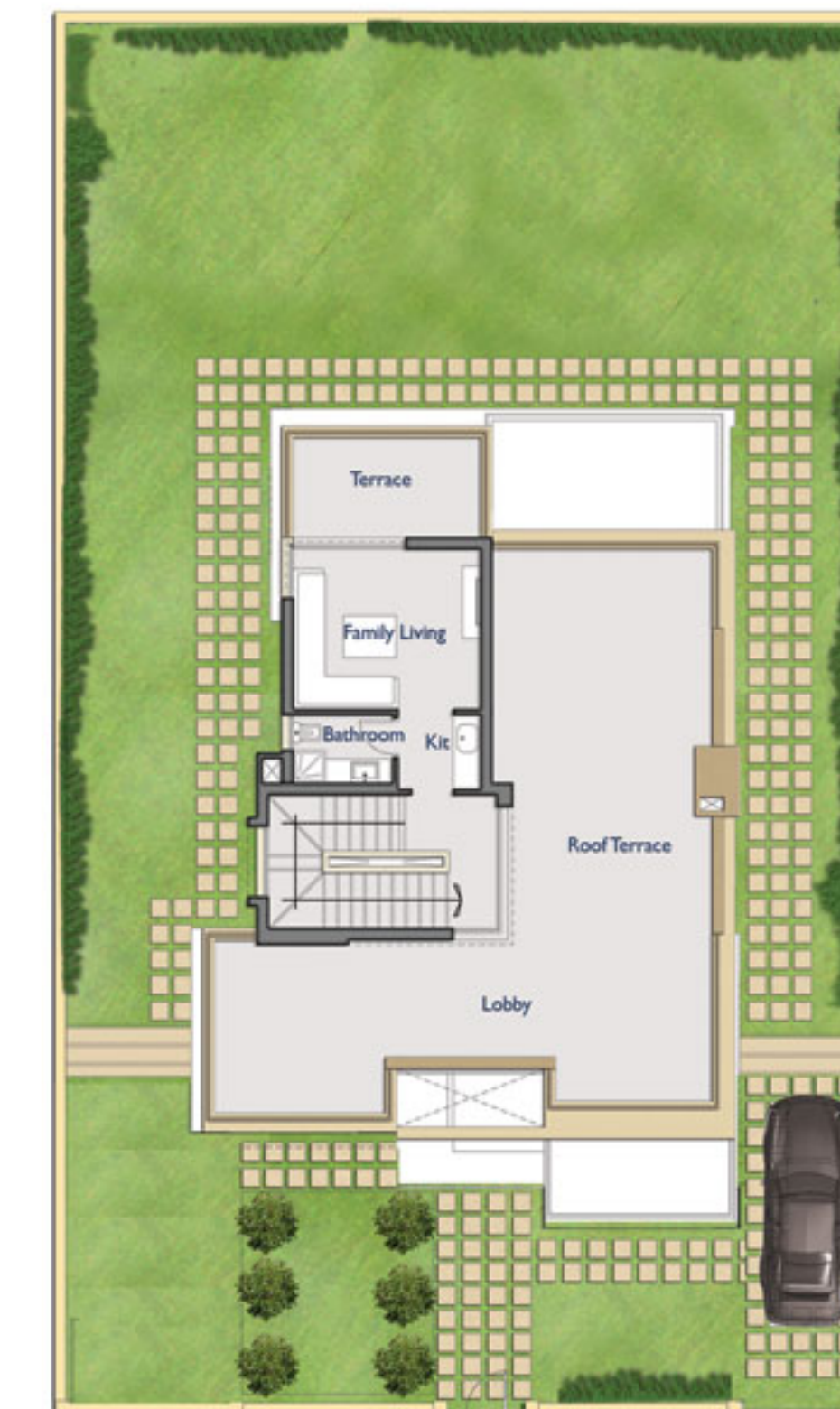

Penthouse